

## 接线片式IGBT吸收电容器

### IGBT Snubber Film Capacitor with Lug terminals

■ 外形图 Outline Drawing

Style 1(端子类型1)

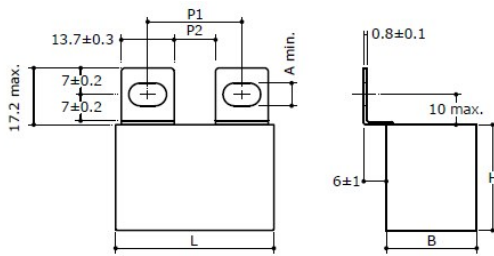

Style 2(端子类型2)

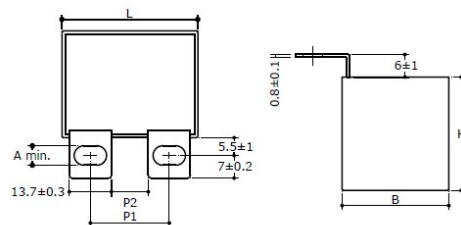

Style 3(端子类型3)

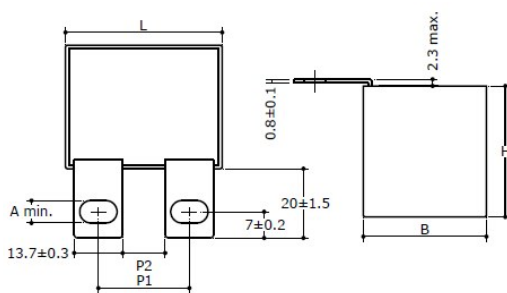

Style 4(端子类型4)

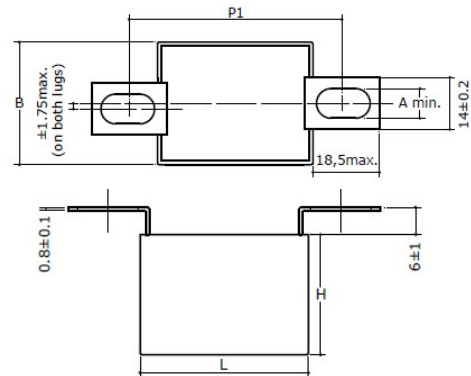

Distance of hole fixing and distance between lugs(mm) 安装孔距和焊片间距				
Lugs syle 焊片形体	L	P1	P2	A
Style 1, 2, 3	42	20~25	8min	6min
		23~28	11min	
	57.5	34~39	21min	
		37~42	24min	
Style 4	42	51~64	37	8min
	57.5	65~78	52	

\*\* Standard fixing slots for M6 screws , slots for M8 screw available upon request.

### ■ 特点

- 双面金属化膜,聚丙烯膜介质, 内部串联结构。
- 损耗小, 内部温升小。
- 塑胶外壳, 阻燃环氧树脂封装。

### ■ 典型应用

- 广泛应用于高压高频脉冲电路中, 特别适合作为 IGBT 吸收电容。

### ■ Features

- Double metallized polyester with metalized Polypropylene film dielectric , internal series connection.
- Low loss and small inherent temperature rise.
- Plastic case, Flame retardant epoxy resin sealing

### ■ Type Application

- Widely used in high voltage, high frequency circuit , especially designed as snubber capacitor for IGBT.

### ■ 技术要求 Specifications

引用标准 Reference Standard	GB/T17702,IEC 61071	
气候类别 Climatic Category	40/85/56	
额定温度 Rated Temperature	85°C	
工作温度范围 Operating Temperature Range	-40°C ~ +85°C	
额定电压 Rated Voltage	700Vdc~3000Vdc	
容量范围 Capacitance range	0.047μF ~ 10μF	
容差 Capacitance tolerance	±5%(J), ±10% (K)	
耐电压 Voltage Proof	1.6× U <sub>N</sub> (DC),10s (between terminals)	
损耗角正切 Dissipation Factor	≤ 0.0005 (1kHz, 20°C)	
绝缘阻抗 Insulation Resistance	≥100 000MΩ, CN≤ 0.33μF	(at 100VDC, 60s , 20~25°C)
	≥30000s CN> 0.33uF	
最大峰值电流 $\hat{I}$ (A)	$\hat{I} = C \cdot dV/dt$	
工作寿命 Operation life time	100 000h at U <sub>N</sub> , $\theta_{hs} \leq 70^\circ\text{C}$	



KWOKTRAN

SGL

Snubber Applications

产品代码说明 Product Code System

■ 产品料号由20位数字组成，如下：

For example: The part number, comprising 20 digits, is formed as follows.

1	2	3	4	5	6	7	8	9	10	11	12	13	14	15	16	17	18	19	20
G	S	L	1	0	5	J	1	M	W	1	9	S	1	H	0	1	9	0	0

第1位	公司代码 G	Digit 1	Company Code G
第2~3位	产品系列代码 SGL(代码)=SL	Digit 2 to 3	Product series Code SGL =SL
第4~6位	容值代码 举例：105=1.0×10 <sup>6</sup> pF=1.0μF	Digit 4 to 6	Rated capacitance value For example : 105=1.0×10 <sup>6</sup> pF=1.0μF
第7位	容量偏差代码 J=±5% ,K=±10%,	Digit 7	Capacitance tolerance Code J=±5% , K=±10%
第8~9位	额定电压代码 1M=700V,3K=850V,3A=1000V, 3B=1200V,4H=1500V, 4M=1700V, 3D=2000V, 3E=2500V, 4F=3000V	Digit 8 to 9	Rated voltage Code 1M=700V,3K=850V,3A=1000V, 3B=1200V,4H=1500V, 4M=1700V, 3D=2000V, 3E=2500V, 4F=3000V
第10~11位	外壳宽度代码 W1=42mm, W2=57.5mm	Digit 10 to 11	Width of case W1=42mm, W2=57.5mm
第12和18位	内部工程设计码:	Digit 12 and 18	Design revision Code for internal use
第13~14位	焊片型号代码 Style1= S1, style2 S2 Style3=S3, style4=S4	Digit 13	Lugs style code Style1= S1, style2 S2 Style3=S3, style4=S4
第15~17位	安装孔距和焊片间距代码	Digit 14 to 16	Distance of hole fixing and distance between lugs

Distance of hole fixing and distance between lugs(mm) 安装孔距和焊片间距				
Lugs syle 焊片形体	L	P1	P2	Code
Style 1, 2, 3	42	20~25	8min	H01,H02...
		23~28	11min	F01, F02,...
	57.5	34~39	21min	W01,W02...
		37~42	24min	V01,V02...
Style 4	42	51~64	37	P01,P02...
	57.5	65~78	52	Y01,Y02...

第19位	焊片孔规格代码 标准孔 M6=0 特制孔位 M8=1	Digit 19	fixing slots code Standard fixing slots M6 screw=0 Fixing slots 8= 1
第20位	产品识别码	Digit 20	product ID for standard and non-standard product

\*\* For inquiry of items out of above range or with special dimensions. Please do not hesitate to contact with us for availability.  
不在本目录范围内的特殊规格或尺寸需求，可联系我们依要求设计。

■外形尺寸 Dimensions(mm)

U <sub>N</sub> 700Vdc, U <sub>S</sub> 1050Vdc, U <sub>R</sub> 380Vac									
C <sub>R</sub>	L	H	B	dv/dt	$\hat{i}$	L <sub>S</sub>	E.SR@ 100KHz	I <sub>max</sub> @70°C 10KHz	Part number
uF	±1.0	±1.0	±1.0	V/us	(A)	(nH)	(mΩ)	(A)	
1.0	42	27.5	24.5	325	325	25	4.3	15	GSL105*1MW1■□□▲▲▲■00
1.2	42	27.5	24.5	325	390	25	3.1	16	GSL125*1MW1■□□▲▲▲■00
1.5	42	30	22	325	487	25	3.4	18	GSL155*1MW1■□□▲▲▲■00
2.0	42	35.5	33.5	325	650	25	3.2	22	GSL205*1MW1■□□▲▲▲■00
2.0	42	37	28	325	650	25	3.2	21.5	GSL205*1MW1■□□▲▲▲■01
2.2	42	35.5	33.5	325	715	25	2.4	22	GSL225*1MW1■□□▲▲▲■00
2.2	42	37	28	325	715	25	3.2	22	GSL225*1MW1■□□▲▲▲■01
2.5	42	35.5	33.5	325	812	25	2.5	23	GSL255*1MW1■□□▲▲▲■00
2.5	42	37	28	325	812	25	2.5	22.5	GSL255*1MW1■□□▲▲▲■01
3.0	42	45	33	325	975	25	2.4	26	GSL305*1MW1■□□▲▲▲■00
3.0	42	45	30	325	975	25	2.4	25.5	GSL305*1MW1■□□▲▲▲■01
3.3	42	45	33	325	1072	25	2.4	26.5	GSL335*1MW1■□□▲▲▲■00
3.3	42	45	30	325	1072	25	2.4	26	GSL335*1MW1■□□▲▲▲■01
3.5	42	45	33	325	1134	25	2.0	27	GSL355*1MW1■□□▲▲▲■00
3.5	42	45	30	325	1134	25	2.0	26.5	GSL355*1MW1■□□▲▲▲■01
4.0	42	45	33	325	1300	25	1.8	32	GSL405*1MW1■□□▲▲▲■00
4.0	57.5	45	30	220	880	35	2.3	27	GSL405*1MW2■□□▲▲▲■00
5.0	57.5	50	35	220	1100	35	2.5	31	GSL505*1MW2■□□▲▲▲■00
5.0	57.5	45	30	220	1100	35	2.5	30.5	GSL505*1MW2■□□▲▲▲■01
5.6	57.5	50	35	220	1232	35	2.0	32	GSL565*1MW2■□□▲▲▲■00
6.8	57.5	50	35	220	1496	35	2.0	32	GSL685*1MW2■□□▲▲▲■00
10	57.5	56	42.5	220	2200	35	1.8	33	GSL106*1MW2■□□▲▲▲■00

备注:

1. “\*” 表示容量误差。 “\*” =capacitance tolerance code, J=±5%, K=±10%, M=±20%.
2. “■” 表示内部特征码 “■” =Internal use.
3. “□□” 表示焊片型号代码 “□□” =Lugs style code
4. “▲▲▲” 表示安装孔距和焊片间距代码 “▲▲▲” =Distance of hole fixing and distance between lugs
5. “I<sub>max</sub>” 是在 f=10kHz, θ<sub>amb</sub>=70°C, Δθ<sub>case</sub>=15.0°C的最大电流有效值。  
“I<sub>max</sub>” =Maximum r.m.s current at 10kHz, θ<sub>amb</sub>=70°C, Δθ<sub>case</sub>=15.0°C.
6. ESR, L<sub>S</sub>为典型值 ESR and L<sub>S</sub> are typical values.

\*\* For inquiry of items out of above range or with special dimensions. Please do not hesitate to contact with us for availability.  
不在本目录范围内的特殊规格或尺寸需求, 可联系我们依要求设计。



KWOKTRAN

SGL

Snubber Applications

■外形尺寸 Dimensions(mm)

U <sub>N</sub> 850Vdc, U <sub>S</sub> 1275Vdc, U <sub>R</sub> 450Vac									
C <sub>R</sub>	L	H	B	dv/dt	$\hat{i}$	L <sub>S</sub>	E.SR@ 100KHz	I <sub>max</sub> @70°C 10KHz	Part number
uF	±1.0	±1.0	±1.0	V/us	(A)	(nH)	(mΩ)	(A)	
0.82	42	27.5	24.5	400	328	25	4.6	15.5	GSL824*3KW1■□□▲▲▲■00
1.0	42	27.5	24.5	400	400	25	4.0	17.5	GSL105*3KW1■□□▲▲▲■00
1.0	42	30	22	400	400	25	4.0	17	GSL105*3KW1■□□▲▲▲■01
1.5	42	35.5	33.5	400	600	25	2.2	23	GSL155*3KW1■□□▲▲▲■00
1.5	42	37	28	400	600	25	2.2	22.5	GSL155*3KW1■□□▲▲▲■01
2.0	42	35.5	33.5	400	800	25	2.2	23.5	GSL205*3KW1■□□▲▲▲■00
2.2	42	45	30	400	880	25	2.2	26.5	GSL225*3KW1■□□▲▲▲■00
2.5	42	45	30	400	1000	25	2.9	26.5	GSL255*3KW1■□□▲▲▲■00
2.5	42	45	33	400	1000	25	2.9	27	GSL255*3KW1■□□▲▲▲■01
3.0	57.5	45	30	280	840	35	3.4	28	GSL305*3KW2■□□▲▲▲■00
3.3	57.5	45	30	280	924	35	3.4	28.5	GSL335*3KW2■□□▲▲▲■00
4.0	57.5	50	35	280	1120	35	2.1	29.5	GSL405*3KW2■□□▲▲▲■00
4.7	57.5	50	35	280	1316	35	2.2	32	GSL475*3KW2■□□▲▲▲■00
6.8	57.5	56	42.5	280	1904	35	1.7	33	GSL685*3KW2■□□▲▲▲■00

U <sub>N</sub> 1000Vdc, U <sub>S</sub> 1500Vdc, U <sub>R</sub> 480Vac									
C <sub>R</sub>	L	H	B	dv/dt	$\hat{i}$	L <sub>S</sub>	E.SR@ 100KHz	I <sub>max</sub> @70°C 10KHz	Part number
uF	±1.0	±1.0	±1.0	V/us	(A)	(nH)	(mΩ)	(A)	
0.68	42	27.5	24.5	500	340	25	5.3	15.0	GSL684*3AW1■□□▲▲▲■00
0.75	42	27.5	24.5	500	375	25	4.7	15.5	GSL754*3AW1■□□▲▲▲■00
0.75	42	30	22	500	375	25	4.7	15.0	GSL754*3AW1■□□▲▲▲■01
1.0	42	37	28	500	500	25	3.5	17.0	GSL105*3AW1■□□▲▲▲■00
1.2	42	35.5	33.5	500	600	25	3.2	22.0	GSL125*3AW1■□□▲▲▲■00
1.2	42	37	28	500	600	25	3.2	21.5	GSL125*3AW1■□□▲▲▲■01
1.5	42	35.5	33.5	500	750	25	2.5	23.5	GSL155*3AW1■□□▲▲▲■00
1.75	42	45	33	500	875	25	2.1	23.5	GSL1755*3AW1■□□▲▲▲■0
1.75	42	45	30	500	875	25	2.1	23.0	GSL1755*3AW1■□□▲▲▲■1
2.0	42	45	33	500	1000	25	2.3	26.5	GSL205*3AW1■□□▲▲▲■00
2.2	57.5	45	30	350	770	35	2.7	26.5	GSL225*3AW2■□□▲▲▲■00
2.5	57.5	45	30	350	875	35	2.9	28.0	GSL255*3AW2■□□▲▲▲■00

\*\* For inquiry of items out of above range or with special dimensions. Please do not hesitate to contact with us for availability.

不在本目录范围内的特殊规格或尺寸需求，可联系我们依要求设计。

■外形尺寸 Dimensions(mm)

U <sub>N</sub> 1000Vdc, U <sub>S</sub> 1500Vdc, U <sub>R</sub> 480Vac									
C <sub>R</sub>	L	H	B	dv/dt	$\hat{i}$	L <sub>S</sub>	E.SR@ 100KHz	I <sub>max</sub> @70°C 10KHz	Part number
uF	±1.0	±1.0	±1.0	V/us	(A)	(nH)	(mΩ)	(A)	
3.0	57.5	50	35	350	1050	35	3.4	31	GSL305*3AW2■□□▲▲▲■00
3.3	57.5	50	35	350	1150	35	2.5	31	GSL335*3AW2■□□▲▲▲■00
5.0	57.5	56	42.5	350	1750	35	1.6	33	GSL505*3AW2■□□▲▲▲■00

U <sub>N</sub> 1200Vdc, U <sub>S</sub> 1800Vdc, U <sub>R</sub> 500Vac									
C <sub>R</sub>	L	H	B	dv/dt	$\hat{i}$	L <sub>S</sub>	E.SR@ 100KHz	I <sub>max</sub> @70°C 10KHz	Part number
uF	±1.0	±1.0	±1.0	V/us	(A)	(nH)	(mΩ)	(A)	
0.22	42	27.5	24.5	650	143	25	12.8	11.5	GSL224*3BW1■□□▲▲▲■00
0.22	42	26	15	650	143	25	12.8	11	GSL224*3BW1■□□▲▲▲■01
0.33	42	27.5	24.5	650	210	25	8.9	12	GSL334*3BW1■□□▲▲▲■00
0.33	42	26	15	650	210	25	8.9	11.5	GSL334*3BW1■□□▲▲▲■01
0.39	42	27.5	24.5	650	254	25	7.3	13	GSL394*3BW1■□□▲▲▲■00
0.39	42	28	17	650	254	25	7.3	12.5	GSL394*3BW1■□□▲▲▲■01
0.47	42	27.5	24.5	650	306	25	7.0	14	GSL474*3BW1■□□▲▲▲■00
0.47	42	30	22	650	306	25	7.0	13.5	GSL474*3BW1■□□▲▲▲■01
0.56	42	27.5	24.5	650	364	25	5.3	14.5	GSL564*3BW1■□□▲▲▲■00
0.56	42	30	22	650	364	25	5.3	14.0	GSL564*3BW1■□□▲▲▲■01
0.68	42	35.5	33.5	650	442	25	4.6	19	GSL684*3BW1■□□▲▲▲■00
0.68	42	30	22	650	442	25	4.6	18.5	GSL684*3BW1■□□▲▲▲■01
0.82	42	35.5	33.5	650	533	25	4.6	19	GSL824*3BW1■□□▲▲▲■00
0.82	42	30	22	650	533	25	4.6	18.5	GSL824*3BW1■□□▲▲▲■01
1.0	42	35.5	33.5	650	650	25	3.4	20.5	GSL105*3BW1■□□▲▲▲■00
1.0	42	30	22	650	650	25	3.4	20	GSL105*3BW1■□□▲▲▲■01
1.0	42	35.5	33.5	650	650	25	3.4	20.5	GSL105*3BW1■□□▲▲▲■00
1.2	42	45	33	650	780	25	3.1	23.5	GSL125*3BW1■□□▲▲▲■00
1.2	42	45	30	650	780	25	4.2	23	GSL125*3BW1■□□▲▲▲■01
1.5	42	45	33	650	975	25	4.1	25	GSL155*3BW1■□□▲▲▲■00
1.5	42	45	30	650	975	25	4.1	24.5	GSL155*3BW1■□□▲▲▲■01
2.0	57.5	45	30	455	910	35	3.6	27	GSL205*3BW2■□□▲▲▲■01
2.2	57.5	50	35	455	1001	35	3.5	30	GSL225*3BW2■□□▲▲▲■00

\*\* For inquiry of items out of above range or with special dimensions. Please do not hesitate to contact with us for availability.  
不在本目录范围内的特殊规格或尺寸需求，可联系我们依要求设计。



KWOKTRAN

SGL

Snubber Applications

■外形尺寸 Dimensions(mm)

U <sub>N</sub> 1200Vdc, U <sub>S</sub> 1800Vdc, U <sub>R</sub> 500Vac									
C <sub>R</sub>	L	H	B	dv/dt	$\hat{i}$	L <sub>S</sub>	E.SR@ 100KHz	I <sub>max</sub> @70°C 10KHz	Part number
uF	±1.0	±1.0	±1.0	V/us	(A)	(nH)	(mΩ)	(A)	
2.2	57.5	45	30	455	1001	35	3.5	29.5	GSL225*3BW2■□□▲▲▲■01
2.5	57.5	50	35	455	1138	35	3.2	31	GSL255*3BW2■□□▲▲▲■00
3.0	57.5	50	35	455	1365	35	3.1	32	GSL305*3BW2■□□▲▲▲■00
4.5	57.5	56	42.5	455	2047	35	3.0	33	GSL455*3BW2■□□▲▲▲■00

U <sub>N</sub> 1500Vdc, U <sub>S</sub> 2550Vdc, U <sub>R</sub> 570Vac									
C <sub>R</sub>	L	H	B	dv/dt	$\hat{i}$	L <sub>S</sub>	E.SR@ 100KHz	I <sub>max</sub> @70°C 10KHz	Part number
uF	±1.0	±1.0	±1.0	V/us	(A)	(nH)	(mΩ)	(A)	
0.33	42	27.5	24.5	800	264	25	7.4	13.5	GSL334*4HW1■□□▲▲▲■00
0.39	42	30	22	800	312	25	7.2	13.5	GSL394*4HW1■□□▲▲▲■00
0.47	42	35.5	33.5	800	376	25	5.3	18	GSL474*4HW1■□□▲▲▲■00
0.47	42	37	28	800	376	25	5.3	17.5	GSL474*4HW1■□□▲▲▲■01
0.68	42	35.5	33.5	800	544	25	4.6	19.5	GSL684*4HW1■□□▲▲▲■00
0.68	42	37	28	800	544	25	4.6	19	GSL684*4HW1■□□▲▲▲■01
0.75	42	35.5	33.5	800	600	25	4.5	20.5	GSL754*4HW1■□□▲▲▲■00
1.0	42	45	33	800	800	25	4.5	23	GSL105*4HW1■□□▲▲▲■00
1.0	42	45	30	800	800	25	4.5	22.5	GSL105*4HW1■□□▲▲▲■01
1.2	57.5	45	30	560	672	35	4.2	25	GSL125*4HW2■□□▲▲▲■00
1.5	57.5	50	35	560	840	35	4.1	28	GSL155*4HW2■□□▲▲▲■00
1.8	57.5	50	35	560	1008	35	4.0	29.5	GSL185*4HW2■□□▲▲▲■00
2.5	57.5	56	42.5	560	1400	35	4.0	31	GSL255*4HW2■□□▲▲▲■00

U <sub>N</sub> 1700Vdc, U <sub>S</sub> 2550Vdc, U <sub>R</sub> 575Vac									
C <sub>R</sub>	L	H	B	dv/dt	$\hat{i}$	L <sub>S</sub>	E.SR@ 100KHz	I <sub>max</sub> @70°C 10KHz	Part number
uF	±1.0	±1.0	±1.0	V/us	(A)	(nH)	(mΩ)	(A)	
0.22	42	27.5	24.5	880	194	25	10.2	13.2	GSL224*4MW1■□□▲▲▲■00
0.22	42	28	17	880	194	25	10.2	13	GSL224*4MW1■□□▲▲▲■01
0.33	42	27.5	24.5	880	290	25	7.9	14	GSL334*4MW1■□□▲▲▲■00
0.33	42	30	22	880	290	25	7.9	13.5	GSL334*4MW1■□□▲▲▲■01

\*\* For inquiry of items out of above range or with special dimensions. Please do not hesitate to contact with us for availability.  
不在本目录范围内的特殊规格或尺寸需求，可联系我们依要求设计。

■外形尺寸 Dimensions(mm)

U <sub>N</sub> 1700Vdc, U <sub>S</sub> 2550Vdc, U <sub>R</sub> 575Vac									
C <sub>R</sub>	L	H	B	dv/dt	$\hat{i}$	L <sub>s</sub>	E.SR@ 100KHz	I <sub>max</sub> @70°C 10KHz	Part number
uF	±1.0	±1.0	±1.0	V/us	(A)	(nH)	(mΩ)	(A)	
0.47	42	35.5	33.5	880	413	25	5.6	19	GSL474*4MW1 ■□□▲▲▲■00
0.47	42	37	28	880	413	25	5.6	18.5	GSL474*4MW1 ■□□▲▲▲■01
0.56	42	35.5	33.5	880	492	25	5.5	19.5	GSL564*4MW1 ■□□▲▲▲■00
0.56	42	37	28	880	492	25	5.5	19	GSL564*4MW1 ■□□▲▲▲■01
0.68	42	35.5	33.5	880	598	25	5.4	20	GSL684*4MW1 ■□□▲▲▲■00
0.82	42	45	33	880	721	25	5.4	22.1	GSL824*4MW1 ■□□▲▲▲■00
0.82	42	45	30	880	721	25	5.4	19.5	GSL824*4MW1 ■□□▲▲▲■01
1.0	57.5	45	30	610	610	35	5.3	23.5	GSL105*4MW1 ■□□▲▲▲■00
1.2	57.5	45	30	610	732	35	4.5	26.2	GSL125*4MW1 ■□□▲▲▲■00
1.5	57.5	50	35	610	915	35	3.7	28.5	GSL155*4MW1 ■□□▲▲▲■00
2.2	57.5	56	42.5	610	1342	35	3.5	30	GSL225*4MW1 ■□□▲▲▲■00

U <sub>N</sub> 2000Vdc, U <sub>S</sub> 3000Vdc, U <sub>R</sub> 630Vac									
C <sub>R</sub>	L	H	B	dv/dt	$\hat{i}$	L <sub>s</sub>	E.SR@ 100KHz	I <sub>max</sub> @70°C 10KHz	Part number
uF	±1.0	±1.0	±1.0	V/us	(A)	(nH)	(mΩ)	(A)	
0.1	42	27.5	24.5	1000	100	25	25.7	8.0	GSL104*3DW1 ■□□▲▲▲■00
0.1	42	26	15	1000	100	25	25.7	7.5	GSL104*3DW1 ■□□▲▲▲■01
0.15	42	27.5	24.5	1000	150	25	14.7	10.5	GSL154*3DW1 ■□□▲▲▲■00
0.15	42	28	17	1000	150	25	14.7	10	GSL154*3DW1 ■□□▲▲▲■01
0.22	42	27.5	24.5	1000	220	25	10.5	12	GSL224*3DW1 ■□□▲▲▲■00
0.22	42	30	22	1000	220	25	10.5	11.5	GSL224*3DW1 ■□□▲▲▲■01
0.33	42	35.5	33.5	1000	330	25	9.5	16.5	GSL334*3DW1 ■□□▲▲▲■00
0.33	42	37	28	1000	330	25	9.5	16	GSL334*3DW1 ■□□▲▲▲■01
0.39	42	35.5	33.5	1000	390	25	6.7	17.5	GSL394*3DW1 ■□□▲▲▲■00
0.39	42	37	28	1000	390	25	6.7	17	GSL394*3DW1 ■□□▲▲▲■01
0.47	42	45	33	1000	470	25	5.2	20.5	GSL474*3DW1 ■□□▲▲▲■00
0.47	42	37	28	1000	470	25	5.2	20	GSL474*3DW1 ■□□▲▲▲■00
0.56	42	45	33	1000	560	25	4.3	21.5	GSL564*3DW1 ■□□▲▲▲■00
0.68	57.5	45	30	700	476	35	5.7	22.5	GSL684*3DW2 ■□□▲▲▲■00
0.82	57.5	45	30	700	574	35	4.5	24	GSL824*3DW2 ■□□▲▲▲■00

\*\* For inquiry of items out of above range or with special dimensions. Please do not hesitate to contact with us for availability.  
不在本目录范围内的特殊规格或尺寸需求, 可联系我们依要求设计。





KWOKTRAN

SGL

Snubber Applications

■外形尺寸 Dimensions(mm)

U <sub>N</sub> 2000Vdc, U <sub>S</sub> 3000Vdc, U <sub>R</sub> 630Vac									
C <sub>R</sub>	L	H	B	dv/dt	$\hat{i}$	L <sub>S</sub>	E.SR@ 100KHz	I <sub>max</sub> @70°C 10KHz	Part number
uF	±1.0	±1.0	±1.0	V/us	(A)	(nH)	(mΩ)	(A)	
1.0	57.5	50	30	700	700	35	4.5	27	GSL105*3DW2■□□▲▲▲■00
1.2	57.5	45	30	700	840	35	4.2	29	GSL125*3DW2■□□▲▲▲■00
1.8	57.5	56	42.5	700	1260	35	4.0	31	GSL185*3DW2■□□▲▲▲■00

U <sub>N</sub> 2500Vdc, U <sub>S</sub> 3750Vdc, U <sub>R</sub> 700Vac									
C <sub>R</sub>	L	H	B	dv/dt	$\hat{i}$	L <sub>S</sub>	E.SR@ 100KHz	I <sub>max</sub> @70°C 10KHz	Part number
uF	±1.0	±1.0	±1.0	V/us	(A)	(nH)	(mΩ)	(A)	
0.1	42	27.5	24.5	1350	135	25	18.7	9.0	GSL104*3EW1■□□▲▲▲■00
0.15	42	30	22	1350	202	25	13.5	10.5	GSL154*3EW1■□□▲▲▲■00
0.22	42	37	28	1350	297	25	10.2	14.5	GSL224*3EW1■□□▲▲▲■00
0.33	42	45	33	1350	445	25	7.8	18	GSL334*3EW1■□□▲▲▲■00
0.47	57.5	45	30	945	444	35	6.2	22	GSL474*3EW1■□□▲▲▲■00
0.56	57.5	45	30	945	530	35	6.2	22.5	GSL564*3EW1■□□▲▲▲■00
0.68	57.5	50	35	945	642	35	5.5	25	GSL684*3EW1■□□▲▲▲■00
0.75	57.5	50	35	945	709	35	5.1	25.5	GSL754*3EW1■□□▲▲▲■00
1.0	57.5	56	42.5	945	945	35	4.8	28	GSL105*3EW1■□□▲▲▲■00

U <sub>N</sub> 3000Vdc, U <sub>S</sub> 4500Vdc, U <sub>R</sub> 750Vac									
C <sub>R</sub>	L	H	B	dv/dt	$\hat{i}$	L <sub>S</sub>	E.SR@ 100KHz	I <sub>max</sub> @70°C 10KHz	Part number
uF	±1.0	±1.0	±1.0	V/us	(A)	(nH)	(mΩ)	(A)	
0.047	42	27.5	24.5	1600	75	25	31.6	7.4	GSL473*4FW1■□□▲▲▲■00
0.047	42	26	15	1600	75	25	31.6	7.0	GSL473*4FW1■□□▲▲▲■01
0.068	42	27.5	24.5	1600	108	25	22.7	9.0	GSL683*4FW1■□□▲▲▲■00
0.068	42	28	17	1600	108	25	22.7	8.5	GSL683*4FW1■□□▲▲▲■01
0.1	42	35.5	33.5	1600	160	25	15	12	GSL104*4FW1■□□▲▲▲■00
0.1	42	30	22	1600	160	25	15	11.5	GSL104*4FW1■□□▲▲▲■01
0.15	42	35.5	33.5	1600	240	25	10.8	14.5	GSL154*4FW1■□□▲▲▲■00
0.15	42	37	28	1600	240	25	10.8	14.0	GSL154*4FW1■□□▲▲▲■01
0.22	42	45	33	1600	352	25	6.6	17.6	GSL224*4FW1■□□▲▲▲■00

\*\* For inquiry of items out of above range or with special dimensions. Please do not hesitate to contact with us for availability.  
不在本目录范围内的特殊规格或尺寸需求，可联系我们依要求设计。

### ■外形尺寸 Dimensions(mm)

U <sub>N</sub> 3000Vdc, U <sub>S</sub> 4500Vdc, U <sub>R</sub> 750Vac									
C <sub>R</sub>	L	H	B	dv/dt	$\hat{i}$	L <sub>S</sub>	E.SR@ 100KHz	I <sub>max</sub> @70°C 10KHz	Part number
uF	±1.0	±1.0	±1.0	V/us	(A)	(nH)	(mΩ)	(A)	
0.22	42	45	30	1600	352	25	6.6	17	GSL224*4FW1■□□▲▲▲■01
0.33	57.5	45	30	870	288	35	7.5	21	GSL334*4FW2■□□▲▲▲■00
0.47	57.5	50	35	870	408	35	7.5	23	GSL474*4FW2■□□▲▲▲■00
0.56	57.5	50	35	870	487	35	7.4	23	GSL564*4FW2■□□▲▲▲■00
0.82	57.5	56	42.5	870	714	35	7.0	26	GSL824*4FW2■□□▲▲▲■00

备注:

4. “\*” 表示容量误差。 “\*” =capacitance tolerance code, J=±5%, K=±10%, M=±20%.
5. “■” 表示内部特征码 “■” =Internal use.
6. “□□” 表示焊片型号代码 “□□” =Lugs style code
4. “▲▲▲” 表示安装孔距和焊片间距代码 “▲▲▲” =Distance of hole fixing and distance between lugs
5. “I<sub>max</sub>” 是在 f=10kHz, θ<sub>amb</sub>=70°C, Δθ<sub>case</sub>=15.0°C的最大电流有效值。  
“I<sub>max</sub>” =Maximum r.m.s current at 10kHz, θ<sub>amb</sub>=70°C, Δθ<sub>case</sub>=15.0°C.
6. ESR, L<sub>S</sub>为典型值 ESR and L<sub>S</sub> are typical values.